

Service and spare parts use of the PR18 sheeter pivot design S1001ERN167 & S1001MOD191

Due to on-going improvement to the PR18 product the original sheeter pivot has been replaced with a new design. The fixed bracketry of the original design has been superseded by a bolt on replaceable design with new pins and fixing arrangement.

This system has been introduced to overcome observations raised by customers and to increase the robustness to operational factors.

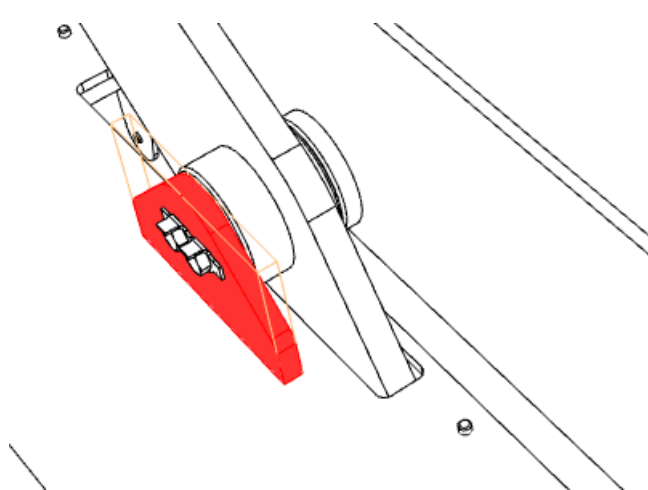

Design to August 2020

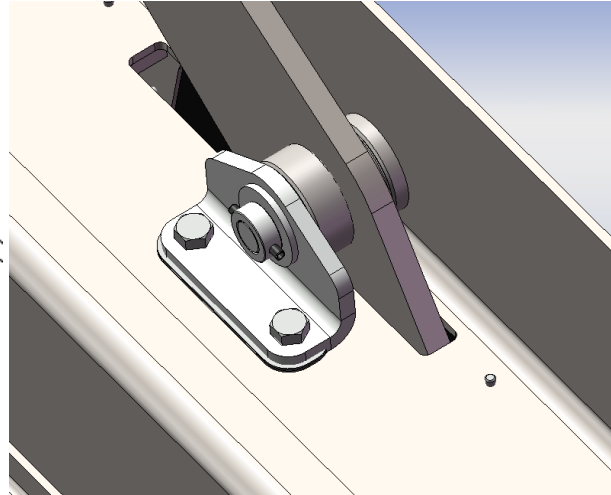

Design from August 2020

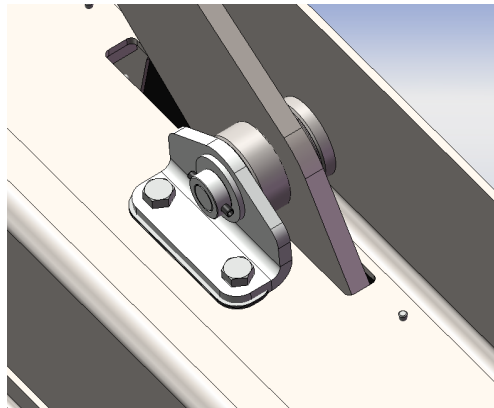

This cut in to new builds as of August 2020 on the customer Firow skip loaders serial number R59826-R59829 and on future builds.

Information relating to this new part introduction.

note: The repair fitment of the design or retro fitment needs careful consideration to the dimension of the skip frame.

- Retrofitting requires the previous design fixed bracket to be cut off both side of the frame and the area where these brackets were ground level before the new bracket alignment process is instigated.
- Alignment of the bracket should be made prior to bolting down the two fixing bolts 12mm x 50mm - 8.8 or drilling the 12mm holes on the frame. Shims are available if there is a gap between the bracket and the frame when aligned with the pin through the frame.
- The gap between the frame and the bracket could be up to 5mm.
- The torque setting for the bolts is 55lbs ft or 72Nm
- The collar and roll pins should be fitted after the pin and bracket has been aligned

<u>New parts introduced/ per frame:</u>	
QTY	Part number
2 x	S1001-SS-660 Bracket
2x	S1001-SS-661 Pivot pin
2x	S1001-SS-662 Washer
Upto 14 x	S1001-SS-666 Shim
2x	S1001-SS-683 Collar
2x	SLOTTED SPRING PIN 6X45